

Declaring the intent to vacate a portion of Muriel Court S.W. (10 feet wide)

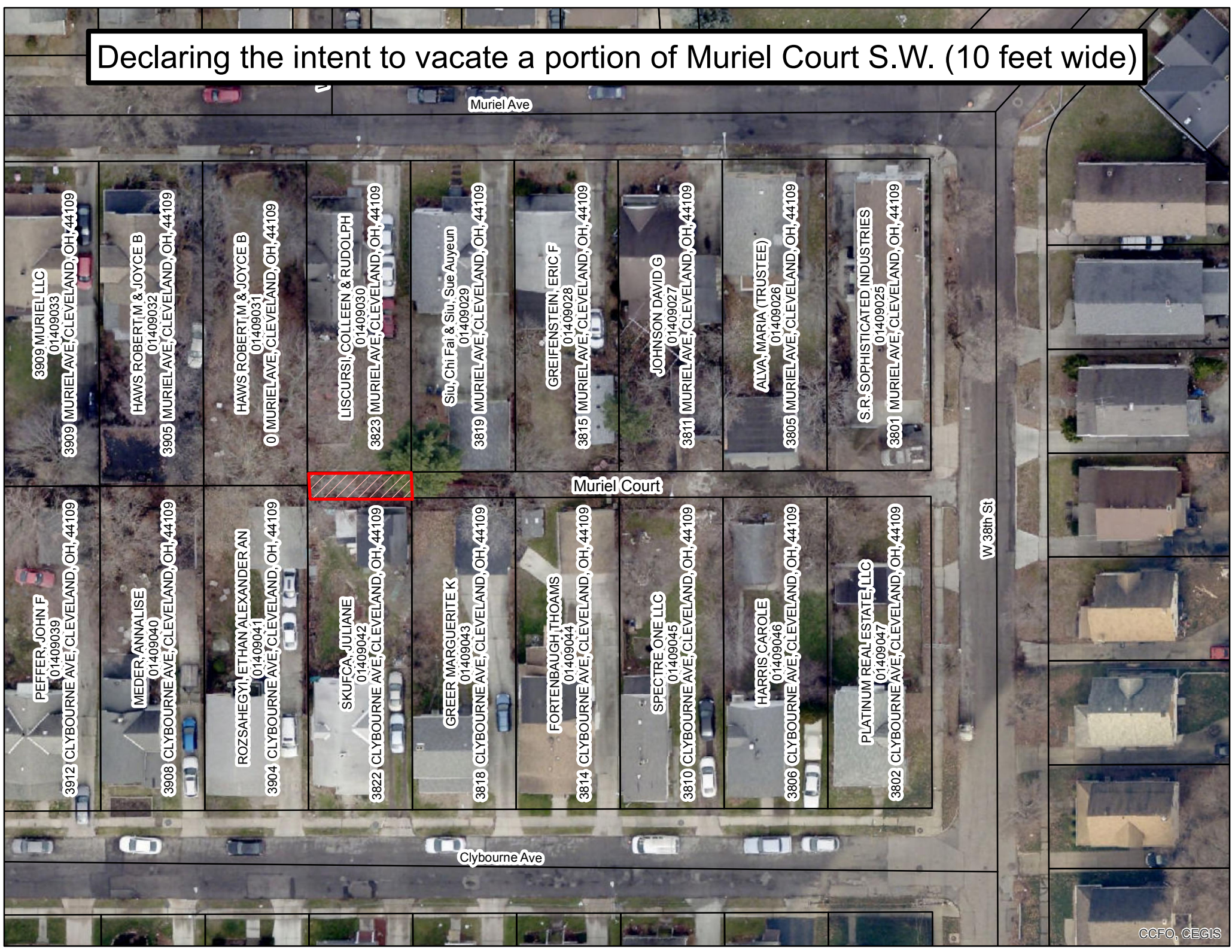

Muriel Ave

3909 MURIEL LLC  
01409033  
3909 MURIEL AVE, CLEVELAND, OH, 44109

HAWS ROBERT, M. & JOYCE B  
01409032  
3905 MURIEL AVE, CLEVELAND, OH, 44109

HAWS ROBERT, M. & JOYCE B  
01409031  
0 MURIEL AVE, CLEVELAND, OH, 44109

LISCURSI, COLLEEN & RUDOLPH  
01409030  
3823 MURIEL AVE, CLEVELAND, OH, 44109

Siu, Chi Fai & Siu, Sue Auyeun  
01409029  
3819 MURIEL AVE, CLEVELAND, OH, 44109

GREIFENSTEIN, ERIC F  
01409028  
3815 MURIEL AVE, CLEVELAND, OH, 44109

JOHNSON DAVID G  
01409027  
3811 MURIEL AVE, CLEVELAND, OH, 44109

ALVA, MARIA (TRUSTEE)  
01409026  
3805 MURIEL AVE, CLEVELAND, OH, 44109

S.R. SOPHISTICATED INDUSTRIES  
01409025  
3801 MURIEL AVE, CLEVELAND, OH, 44109

PEFFER, JOHN F  
01409039  
3912 CLYBOURNE AVE, CLEVELAND, OH, 44109

MIEDER, ANNALISE  
01409040  
3908 CLYBOURNE AVE, CLEVELAND, OH, 44109

ROZSAHEGYI, ETHAN ALEXANDER AN  
01409041  
3904 CLYBOURNE AVE, CLEVELAND, OH, 44109

SKUFCA, JULIANE  
01409042  
3822 CLYBOURNE AVE, CLEVELAND, OH, 44109

GREER MARGUERITE K  
01409043  
3818 CLYBOURNE AVE, CLEVELAND, OH, 44109

FORTENBAUGH, THOAMS  
01409044  
3814 CLYBOURNE AVE, CLEVELAND, OH, 44109

SPECTRE ONE LLC  
01409045  
3810 CLYBOURNE AVE, CLEVELAND, OH, 44109

HARRIS, CAROLE  
01409046  
3806 CLYBOURNE AVE, CLEVELAND, OH, 44109

PLATINUM REAL ESTATE, LLC  
01409047  
3802 CLYBOURNE AVE, CLEVELAND, OH, 44109

Muriel Court

Clybourne Ave

W 38th St