

Location Map: Temporary Easement at Canal Basin Parking Lot

PARCEL #	TOTAL AREA	AREA OF OVERLAP (ACRES)
9-T	0.9125	9-T
AERIAL ESMT.		0.7880

CUY-6-14.56
CUYAHOGA COUNTY
CITY OF CLEVELAND
BROOKLYN TOWNSHIP
ORIGINAL LOT 70

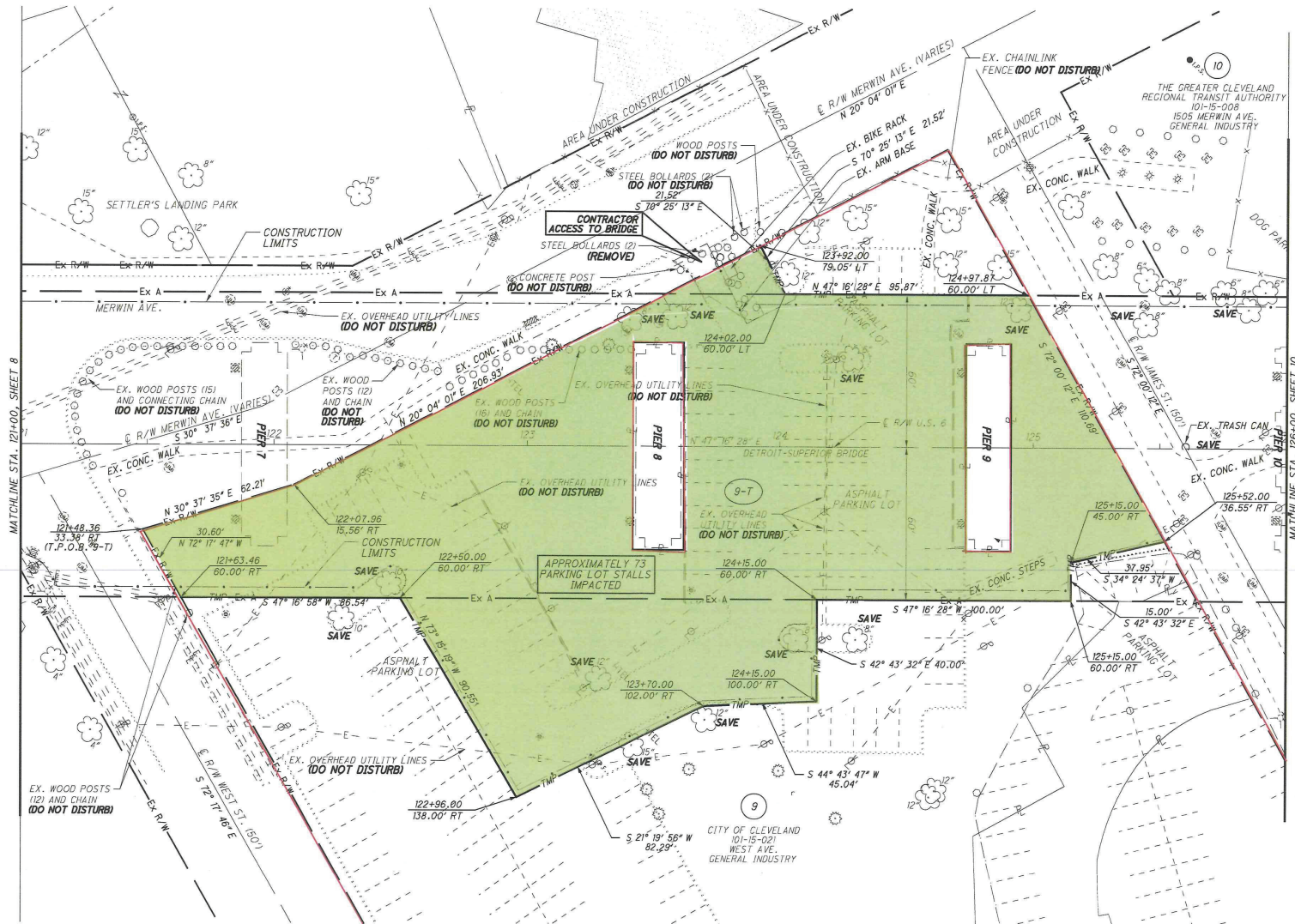

HORIZONTAL
SCALE IN FEET

0 10 20 30

PID NO.

99972

R/W DESIGNER

DTB

R/W REVIEWER

SMH

RIGHT OF WAY DETAIL SHEET

STA. 121+00 TO STA. 126+00

CUY-6-14.56

9 / 10

137
138

F:\Jobs\997 - CUY-6 Survey and RW\99972\row\sheets\99972RT005.dgn 6/14/2018 3:29:21 PM sahoran

